

ATC-05-073
PRI: 115/230V 60/50Hz
SEC: 12V 2.33Ax2

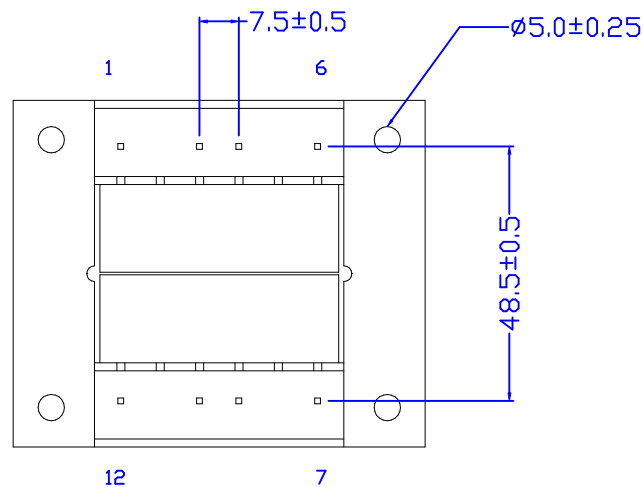

PIN#2,5,8,11 CUT OFF

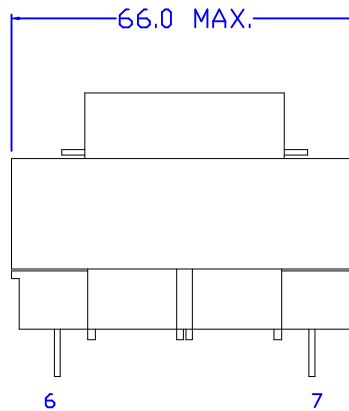
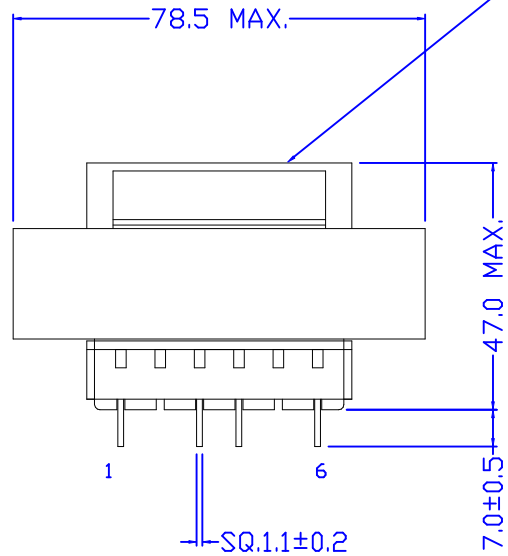
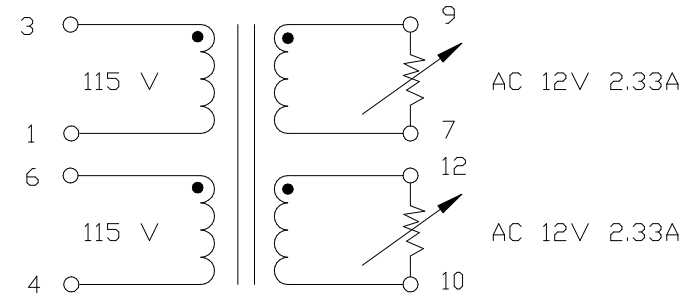

ELECTRICAL CHARACTERISTICS :

1. PRIMARY RATED VOLTAGE AND FREQUENCY : 230/115 V 50/60 Hz
2. EXCITING CURRENT : INPUT PRIMARY 230/115 V 50/60 Hz 130 mA MAX.
3. SECONDARY RATED VOLTAGE :

INPUT VOLTAGE	COLOR/PIN NO.	RATED VOLTAGE	RATED CURRENT	VOLTAGE REGULATION	NO LOAD VOLTAGE
230V 50Hz	9-7	12V AC±5%	2.33A		14.0V AC±5%
1-(3+4)-6	12-10	12V AC±5%	2.33A		14.0V AC ±5%
115V 60Hz	9-7	12V AC±5%	2.33A		14.0V AC±5%
(1+4)-(3+6)	12-10	12V AC±5%	2.33A		14.0V AC ±5%

4. HI-POT TEST : SHALL WITHSTAND WITHOUT BREAKDOWN, INPUT 50Hz LEAKAGE CURRENT 5 mA/1MIN.
4.0 KV FOR ONE MINUTE BETWEEN PRIMARY TO SECONDARY.
4.0 KV FOR ONE MINUTE BETWEEN PRIMARY TO CORE.
4.0 KV FOR ONE MINUTE BETWEEN SECONDARY TO CORE.
5. INSULATION TEST : 500VDC 100 M OHM MIN. BETWEEN WINDINGS AND WINDINGS AND CORE.

						<div><div><div>Atech®</div><div>Atech Technology Co., Ltd.</div><div>TEL:02-2794-6667 FAX:02-2794-8004</div></div></div>		TITLE POWER TRANSFORMER	
								DWG. NO. ATC-05-073	
	RELEASE	12/02/2005	BART	AL	SUEDY	UNITS: M/M	SAFETY	SHEET 1 OF 1	
NO.	DESCRIPTION	DATE	BY	CHK	APPD	DATE		DRAW <i>Pair</i>	
REVISIONS						12/02/05			