



YONGCHENG

SPECIFICATION FOR APPROVAL

DATE: NOV 03, 2010

SAMPLE Q'TY 12 PCS

CUSTOMER : ACUWA

CUSTOMER P/N: SM51616EL

YONGCHENG P/N : YG-24S01B

DESCRIPTION : 1000BASE-T MAGNETICS MODULES

APPROVED SIGNATURES	
YONGCHENG APPROVED SIGNATURES	CUSTOMER APPROVED SIGNATURES
APPROVED BY: LiaoZhongCheng	APPROVED BY:
DATE: 2010/11/03	DATE:
APPROVED No. :	APPROVED No. :

YONGCHENG(ZUNYI) ENTERPRISE INC.

LanGongShan,ZunYi City,GuiZhou,China

Tel: 0852-3162322 13087896733 Fax: 0852-3162322 E-mail<lzc0818@163.com

1000BASE-T MAGNETICS MODULES

P/N:YG-24S01B DATA SHEET(REFERENCE BOURNS SM51616EL)



YONGCHENG
ELECTRONIC CORP.

Page : 1/3

Feature

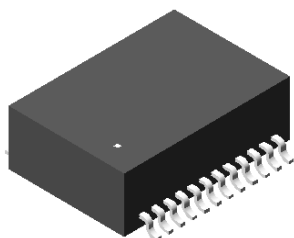

- ◆ Peak reflow temperature rating 235°C
- ◆ Designed to meet IEEE802.3u requirement
- ◆ Pb free Soldering Heat Withstanding
- ◆ Operating temperature range : 0°C to +70°C.
- ◆ Storage temperature range: 0°C to +85°C.

Electrical Specifications @ 25°C

Part Number	Turns Ratio TX/RX (+/-5%)	HI-POT (Vrms)	DCMRR (dB Min)			Cross talk (dB Min)		
			30MHz	60MHz	100MHz	30MHz	60MHz	100MHz
YG-24S01B	1CT:1CT	2250	-43	-37	-33	-45	-40	-35

Continue

Part Number	Insertion Loss (dB Max)	OCL(uH Min) 100KHz/0.1V with 8mA/DC Bias	Return Loss (dB Min)				
	1-100MHz		1-30MHz	40MHz	50MHz	60-80MHz	100MHz
YG-24S01B	-1.0	350	-18	-14.4	-13.1	-12	-10

Mechanical

Schematic

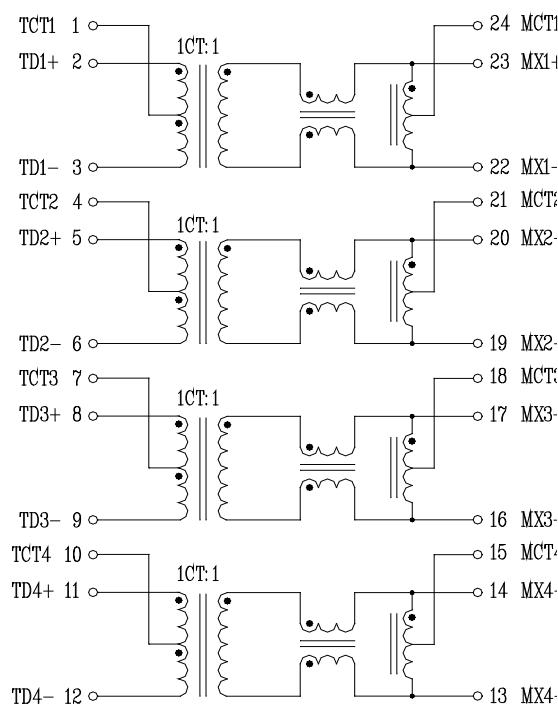

PART NO.	SM51616EL	DATE	2010/11/03								
DESCRIPTION	TRANSFORMER										
ITEM	TEST CONDITION @ 25 ℃	SAMPLES NO. TEST PIN	1	2	3	4	5	SPECIFICATION			
								Min	Typ	Max	
HI-POT(Vrms)	1500Vrms	PRI/SEC	PASS	PASS	PASS	PASS	PASS	1S			
OCL(uH Min)	100KHz/0.1V with 8mA/DC Bias	2-3	451	453	462	398	396	350			
		5-6	429	433	418	468	369				
		8-9	418	415	467	414	430				
		11-12	439	402	413	476	396				
TURN RATIO (±5%) TX/RX	1MHz/sine wave	2-3 : 23-23	PASS	PASS	PASS	PASS	PASS	1CT:1CT			
		5-6 : 20-19	PASS	PASS	PASS	PASS	PASS				
		8-9 : 17-16	PASS	PASS	PASS	PASS	PASS				
		11-12 : 14-13	PASS	PASS	PASS	PASS	PASS				
Insertion Loss (dB)	1-100MHz	2-3 TO 23-23	PASS	PASS	PASS	PASS	PASS	-1			
		5-6 TO 20-19	PASS	PASS	PASS	PASS	PASS				
		8-9 TO 17-16	PASS	PASS	PASS	PASS	PASS				
		11-12 TO 14-13	PASS	PASS	PASS	PASS	PASS				
Return Loss(dB)	1-30 MHz	2-3 TO 23-23	PASS	PASS	PASS	PASS	PASS	-18			
		5-6 TO 20-19	PASS	PASS	PASS	PASS	PASS				
		8-9 TO 17-16	PASS	PASS	PASS	PASS	PASS				
		11-12 TO 14-13	PASS	PASS	PASS	PASS	PASS				
	40 MHz	2-3 TO 23-23	PASS	PASS	PASS	PASS	PASS	-14.4			
		5-6 TO 20-19	PASS	PASS	PASS	PASS	PASS				
		8-9 TO 17-16	PASS	PASS	PASS	PASS	PASS				
		11-12 TO 14-13	PASS	PASS	PASS	PASS	PASS				
	50 MHz	2-3 TO 23-23	PASS	PASS	PASS	PASS	PASS	-13.1			
		5-6 TO 20-19	PASS	PASS	PASS	PASS	PASS				
		8-9 TO 17-16	PASS	PASS	PASS	PASS	PASS				
		11-12 TO 14-13	PASS	PASS	PASS	PASS	PASS				
	60-80 MHz	2-3 TO 23-23	PASS	PASS	PASS	PASS	PASS	-12			
		5-6 TO 20-19	PASS	PASS	PASS	PASS	PASS				
		8-9 TO 17-16	PASS	PASS	PASS	PASS	PASS				
		11-12 TO 14-13	PASS	PASS	PASS	PASS	PASS				
	100 MHz	2-3 TO 23-23	PASS	PASS	PASS	PASS	PASS	-10			
		5-6 TO 20-19	PASS	PASS	PASS	PASS	PASS				
		8-9 TO 17-16	PASS	PASS	PASS	PASS	PASS				
		11-12 TO 14-13	PASS	PASS	PASS	PASS	PASS				
REMARK:											

SAMPLES TEST REPORT



YONGCHENG
ELECTRONIC CORP.

Page : 3/4

Page : 5/7

PART NO.	SM51616EL	DATE	2010/11/03									
DESCRIPTION	TRANSFORMER											
ITEM	TEST CONDITION @ 25 ℃	SAMPLES NO. TEST PIN	1	2	3	4	5	SPECIFICATION				
								Min	Typ	Max		
Cross Talk(dB)	30 MHz	2-3, 23-23 TO 5-6 , 20-19	PASS	PASS	PASS	PASS	PASS	-45				
		8-9, 17-16 TO 11-12, 14-13	PASS	PASS	PASS	PASS	PASS					
	60 MHz	2-3, 23-23 TO 5-6 , 20-19	PASS	PASS	PASS	PASS	PASS	-40				
		8-9, 17-16 TO 11-12, 14-13	PASS	PASS	PASS	PASS	PASS					
	100 MHz	2-3, 23-23 TO 5-6 , 20-19	PASS	PASS	PASS	PASS	PASS	-35				
		8-9, 17-16 TO 11-12, 14-13	PASS	PASS	PASS	PASS	PASS					
HI-POT (Vrms)	2250 HI-POT (1MA)	PRI TO SEC	PASS	PASS	PASS	PASS	PASS					
			PASS	PASS	PASS	PASS	PASS					
			PASS	PASS	PASS	PASS	PASS					
			PASS	PASS	PASS	PASS	PASS					
DCMRR (dB)	30 MHz	2-3 TO 23-23	PASS	PASS	PASS	PASS	PASS	-43				
		5-6 TO 20-19	PASS	PASS	PASS	PASS	PASS					
		8-9 TO 17-16	PASS	PASS	PASS	PASS	PASS					
		11-12 TO 14-13	PASS	PASS	PASS	PASS	PASS					
	60 MHz	2-3 TO 23-23	PASS	PASS	PASS	PASS	PASS	-37				
		5-6 TO 20-19	PASS	PASS	PASS	PASS	PASS					
		8-9 TO 17-16	PASS	PASS	PASS	PASS	PASS					
		11-12 TO 14-13	PASS	PASS	PASS	PASS	PASS					
	100 MHz	2-3 TO 23-23	PASS	PASS	PASS	PASS	PASS	-33				
		5-6 TO 20-19	PASS	PASS	PASS	PASS	PASS					
		8-9 TO 17-16	PASS	PASS	PASS	PASS	PASS					
		11-12 TO 14-13	PASS	PASS	PASS	PASS	PASS					
REMARK:												



YONGCHENG ELECTRONIC CORP.

SAMPLES PACK SPECIFICATIONS

Page: 4/4

CUSTOMER	ACUWA	CUST P/N.	SM51616EL
ITEM	TRANSFORMER	DESCRIPTION	YG-24S01B
PART NO.	818-02780	DATE	2010/11/03

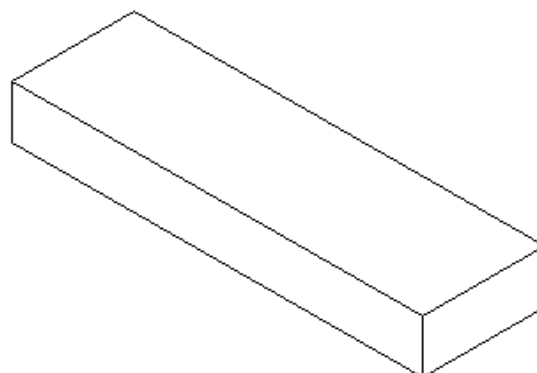
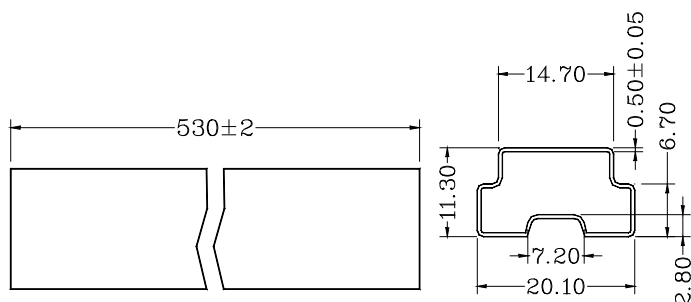

Units:mm Tolerances: $xx.xx0 \pm 0.25$
 $x.x0 \pm 0.25$

TUBE MECHANICAL DIMENSION

INNER CARTON :540*160*70

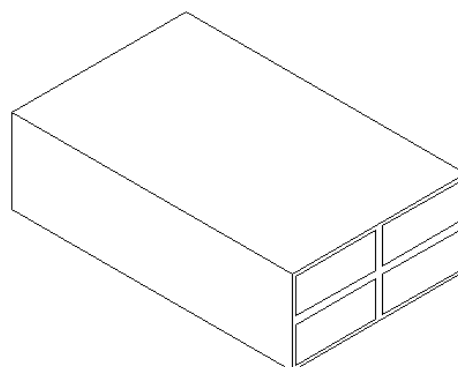
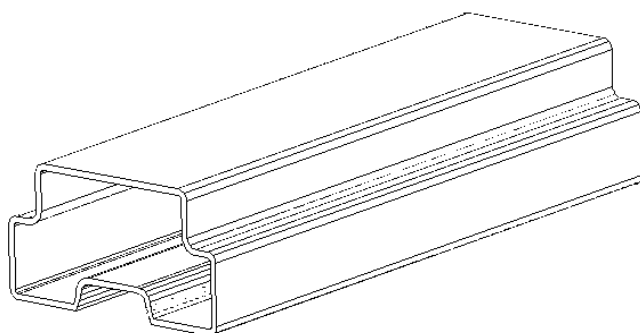

TUBE =29 PCS

INNER CARTON=42 TUBE=42*29=1218PCS

EXPORT CAPTON : 560*340*160

EXPORT CARTON=4INNER CARON=4*1218=4872PCS

REMARK:	APPROVAL	CHECKED	DRAWN BY
	廖忠誠		覃小彬